

DRAWING FOR CUSTOMER

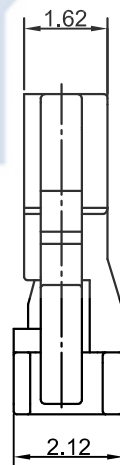
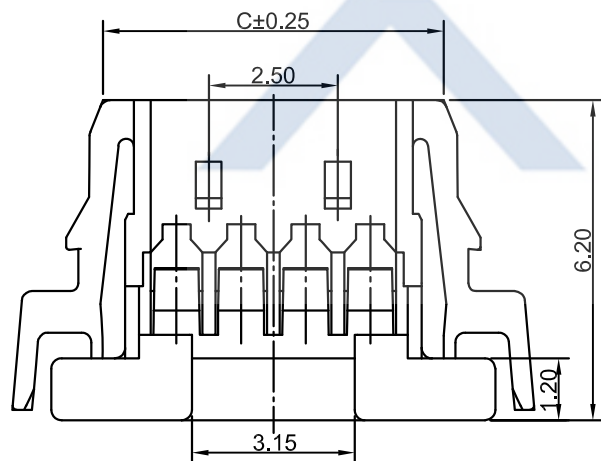
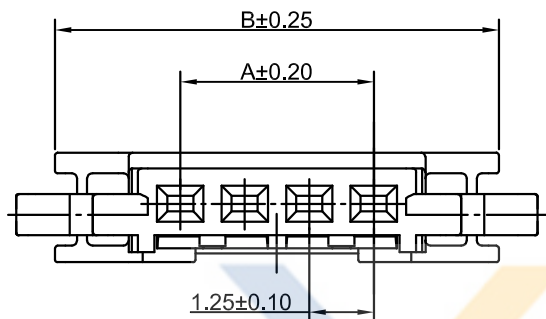
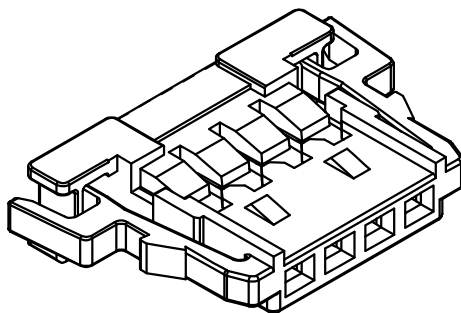

Specifications:

Electrical

- Rated Voltage: 125V AC,DC
- Rated Current: 1A AC,DC
- Withstand Voltage: 250V AC/minute
- Contact Resistance: 20mΩ (MAX.)
- Insulation Resistance: 100MΩ (MIN.)
- Temperature Range: -40°C~+85°C
- Material: PA66 UL94V-0
- Applicable Wire: AWG#28~32

Poles	Part No.	Dimensions(mm)		
		A	B	C
2	KB916-02HL4A	1.25	6.10	4.10
3	KB916-03HL4A	2.50	7.35	5.35
4	KB916-04HL4A	3.75	8.60	6.60
5	KB916-05HL4A	5.00	8.85	7.85
6	KB916-06HL4A	6.25	11.10	9.10
7	KB916-07HL4A	7.50	12.35	10.35
8	KB916-08HL4A	8.75	13.60	11.60
9	KB916-09HL4A	10.00	14.85	12.85
10	KB916-10HLXA	11.25	16.10	14.10
11	KB916-11HL4A	12.50	17.35	15.35
12	KB916-12HL4A	13.75	18.60	16.60
14	KB916-14HL4A	16.25	19.85	17.85
15	KB916-15HL4A	17.50	21.10	19.10
20	KB916-16HL4A	23.75	27.35	25.35
30	KB916-20HL4A	36.25	39.85	37.85

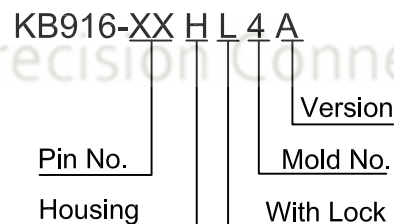

XYCO PRECISION CONNECTORS

TEL: 0769-8297 9981/2/3 <http://www.XYCO.com.cn>

DATE 2014-10-08		VER A	CHANGE HISTORY	CHANGED NAME KB916-XXHL4A	DRAWING John	TOLERANCE 公差	DRAWING 設計者	John	PART NO. 料號		UNIT 單位	mm	PRODUCT NAME 產品名稱	MOLEX51146 PH1.25mm Wire To Board Housing With Lock	
DATE 日期	VER 版本	CHANGE HISTORY 變更歷史	CHANGED NAME 修改後料號	DRAWING 變更者	TOLERANCE 公差	DRAWING 設計者	John	CHECKED 審查	Thomas	DWG NO. 圖號	PE3205A	UNIT 單位	mm	PRODUCT NAME 產品名稱	MOLEX51146 PH1.25mm Wire To Board Housing With Lock
					.X=±0.30 .XX=±0.20 .XXX=±0.10	APPROVED 核准	William								

DRAWING FOR CUSTOMER

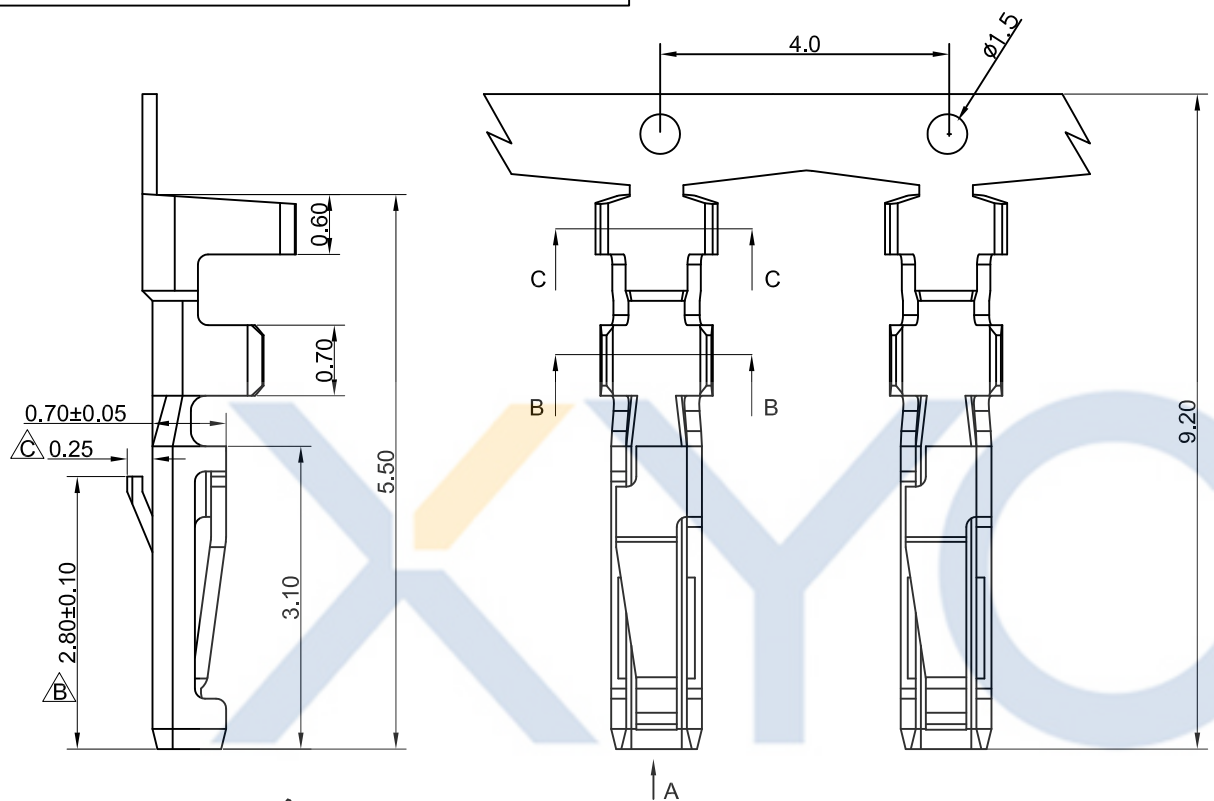

- SPEC.:
- Rated Voltage:125V AC,DC
 - Rated Current:1A AC,DC
 - Withstand Voltage:250V AC/minute
 - Contact Resistance:20mΩ max
 - Insulation Resistance:100MΩ min
 - Temperature Range:-40℃~+85℃
 - Salt Spray Test:48H

- Terminal
- Material:Phosphor Bronze C5191
 - Finish:Gold-plated 3u"Min,over Nickel 30u"Min
 - Applicable wire:AWG#28~32
 - QTY.:15KPCS/Reel

KB916-XXXT1C

- | | |
|-------------------|----------|
| 1:All plated | Version |
| 2:Half plated | |
| Plating | |
| 0: Tin-plated | Terminal |
| 1: Gold Plated1u" | |
| 2: Gold Plated3u" | |
| 3: Gold Plated5u" | Mold No. |

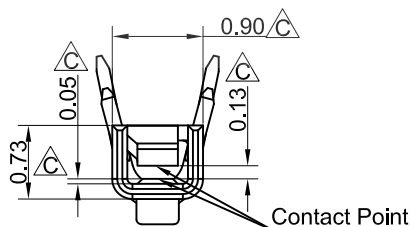
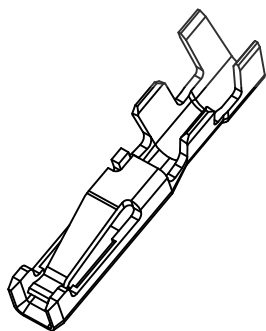

SECTION:A-A

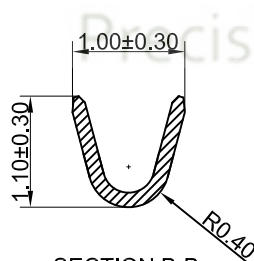

SECTION:B-B

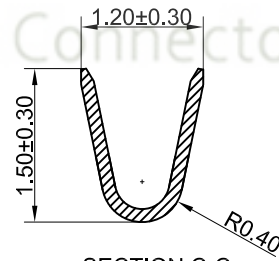

SECTION:C-C

2017-03-04	C	优化尺寸	KB916-XXT1C	John
2016-10-18	B	变更尺寸公差	KB916-XXT1B	John
2015-12-21	A		KB916-XXT1A	John
DATE 日期	VER 版本	CHANGE HISTORY 变更历史	CHANGED NAME 修改后料号	DRAWING 变更者

TOLERANCE 公差	DRAWING 设计者	John
.X=±0.30	CHECKED 审查	Thomas
.XX=±0.20	APPROVED 核准	William
.XXX=±0.10		

KB916-XXT1C	
PART NO. 料号	
DWG NO. 图号	PE3205A

XYCO PRECISION CONNECTORS
 TEL: 0769-8297 9981/2/3 <http://www.XYCO.com.cn>

UNIT 单位	mm	PRODUCT NAME 产品名称	MOLEX51146 PH1.25mm Wire To Board Terminal
------------	----	----------------------	---